



entec HC-Diamond®

Specially designed for black-/
greywater- and Urea tanks.



DESCRIPTION

The **Entec HC-Diamond® series** is most commonly used on (luxury) yachts and cruise ships. Among other things, provided with condensation solutions, the in-/outlet placement is as desired and the size is adjustable. A guaranteed fit.

The filters are also equipped with a high-end coating as standard, so that even a visible location is no problem.

In the odor filter cartridges are placed which are filled with special EnAC® odour filter media, tailored to the application.

With the right filter media you are guaranteed the highest achievable efficiency. In addition, the Entec odor filter cartridges are very easy to replace when they are exhausted.

Included as standard:

- Stainless steel 304L
- High-end coating RAL-9003
- 2x panel lock + key
- Condensation drain point
- EnAC® Filter cartridges + mounting key
- 4x pull nuts for lifting eyes
- Mounting strip



PRODUCT INFORMATION // Odour filters | HC-Diamond Series®

A selection of additional options:

Stainless steel 316L • Double coating • RAL colour of choice • Alternative condensation solutions • Fan • Potentiometer • Espagnolet closure • Special filter media • Custom mounting options • H₂S sensors • Demister • Dust and / or grease trap • Plasma unit • Removable plate instead of door

Specific wishes or requirements?
Entec always has a suitable solution .

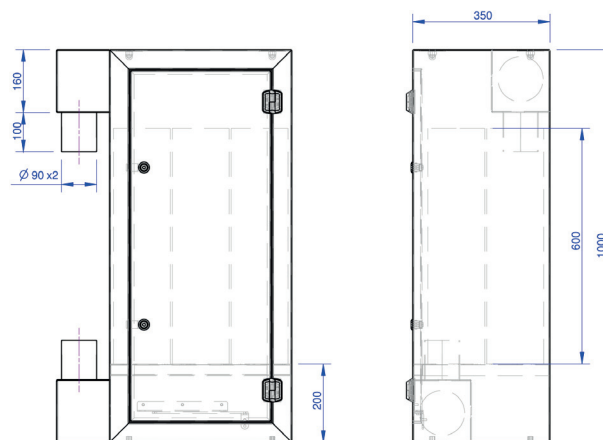

EXAMPLES OF DIFFERENT POSSIBILITIES



Extras:

- Internal condensation solution
- Fan
- Espagnolette lock



Extras:

- Special media for Urea
- Double cartridges
- Espagnolette lock



Extras:

- Stainless steel 316L
- Removable plate
- Maximization of filter media



Extras:

- Plasma unit
- Pump + with gas hose
- Maintenance switch
- ON / OFF switch Plasma unit
- ON / OFF indicator
- Pre-filter

